

## Exd, Weatherproof



## Features

- Zone 1 and Zone 2 use.
- Exd IIC T3/T4.
- ATEX approved, Ex II 2GD.
- UL listed for USA and Canada
  - Hazardous locations:
    - Class I, Div. 2, Groups A, B, C & D.
    - Class I, Zone 1, AExd IIC T3/T4.
  - Ordinary locations: Visual-Signal Device.
- GOST 'R' Certified.
- Brazilian (Inmetro) certified.
- IECEx Gb, Db
- Certified temperature  $-55^{\circ}\text{C}$  to  $+70^{\circ}\text{C}$ .
- Pipe mount or direct mount enclosure.
- Corrosion-free GRP.
- 60W or 100W filament bulb.
- Optional stainless steel backstrap.
- Various lens colours.
- Optional cast or wire lens guard.
- Up to 3 x M20 or 3 x M25 entries.

## Introduction

These certified steady beacons have been designed for use in potentially explosive atmospheres and harsh environmental conditions. The enclosures are suitable for use offshore or onshore, where lightweight combined with corrosion resistance is required.

The housings are manufactured completely from a U.V. stable, glass reinforced polyester.\* Stainless steel screws and mounting bracket are available ensuring a totally corrosion-free product.

Units can be painted to customer specification and supplied with identification labels.

*\*UL pipe mount variants use an alloy lens cover, painted black where applicable.*

**Authorized Distributor:**  
**GasDetectorsUSA.com**  
**Houston, TX USA**  
**832-615-3588**  
**sales@GasDetectorsUSA.com**



# Specification

**Certification:** Certified to IEC60079-0, IEC60079-1, IEC61241-1-1  
 Certified to EN50014, EN50018, EN50281-1-1  
 ATEX Cert. No. Baseefa04ATEX0009X  
 Ex II 2 GD EEx d IIC T3/T4  
 IECEX Cert. No. IECEX BAS 05.0048X  
 Ex d IIC T3/T4 DIP A21  
 UL Listed for USA and Canada:  
 Hazardous locations  
 Class I, Div 2, groups A, B, C & D.  
 Class 1, Zone 1, AExd IIC T3/T4.  
 UL listing No. E187894.  
 Ordinary locations: Visual Signal Device.  
 UL listing No. S8128  
 Brazilian (Inmetro) Certified: BR-Ex d IIC T3/T4/T5/T6  
 GOST 'R' Certification: 1 Exd IIC T3/T4/T5/T6

**Material:** Body: Glass reinforced polyester. (UL Pipe mount - alloy lens cover)  
 Lens: Glass.  
 Backstrap: stainless steel 316.  
 Wire Guard (optional): Stainless steel wire.  
 Cast Guard (optional): Aluminium LM25M.

**Finish:** Natural black or painted to customer specification.

**Models:** FB15 ATEX – Available in direct mount version only.  
 FB15 UL – Available in pipe and direct mount versions.

**Voltage:** 24, 48V d.c. - 110, 120, 230, 240, 254V a.c.

**Lamp Type:** 60W or 100W GLS filament.

**Lamp Holder:** E27 as standard..

**Certified Temp:** 60W: -55°C to +55°C (T4).  
 -55°C to +70°C (T3).  
 100W: -55°C to +40°C (T3).

**Weight:** Pipe mount: 2.6kg; Direct mount: 3.0kg.

**Ingress Protection:** IP66 & IP67.

**Entries:** ATEX version: Supplied as 2 x M20 entries as standard  
 – Up to 3 x M20 or 3 x M25 entries. Contact sales office to order.  
 UL version: Supplied as 2 x 3/4" NPT (direct mount) or 3/4" (pipemount)  
 as standard.  
 Other options available:  
 Up to 3 x 1/2" NPT or 3 x 3/4" NPT (direct mount);  
 1/2" NPT (pipe mount) – contact sales office to order.

**Terminals:** Direct mount: 12 x 2.5mm<sup>2</sup>.  
 Pipe mount: 8 x 2.5mm<sup>2</sup>.

**Labels:** Tag/Duty label option.

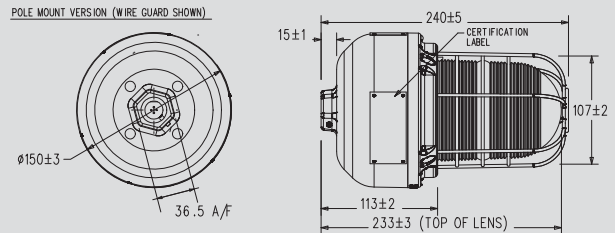
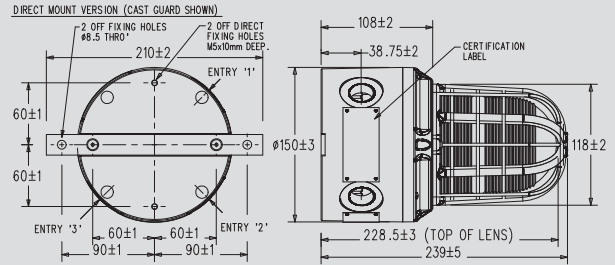

ALL DIMENSIONS IN MILLIMETRES

## Electrical Ratings:

Voltage	d.c.		a.c.				
	24	48	110	120	230	240	254
Current (A) - 60W lamp	2.5	1.25	0.55	0.50	0.26	0.25	0.24
Current (A) - 100W lamp	4.2	2.1	0.91	0.83	0.43	0.42	0.39

## Ordering Requirements

The following code is designed to help in selection of the correct unit. Build up the reference number by inserting the code for each component into the appropriate box. **Standard products available for immediate shipping - contact sales office for details.**

Model	Certification	Voltage	Lamp	Lens Colour	Lens Guard	Fixings	Options	Finish
FB15								

Certification	Code
ATEX	B
IECEX	J
UL	UL
UL (ordinary location)	UW
GOST 'R'	G
Inmetro	DM

Voltage	Code
24V d.c.	024
48V d.c.	048
110V a.c.	110
120V a.c.	120
230V a.c.	230
240V a.c.	240
254V a.c.	254

Wattage	Code
60	60
100	100

Guard	Code
None	N
Cast	C
Wire	W

Option	Code
None	N
Tag label	T*
Duty label	D*
Blanking Plug	P

\* Please specify

Finish	Code
Natural Black	N†
Red	R
Blue	B
Yellow	Y
Green	G
White	W
Special	S*

\* Please Specify  
 † For UL this is painted black

Colour	Code
Red	R
Blue	B
Green	G
Amber	A
Yellow	Y
Clear	C

Fixings	Code
Pipe mount	P*†
Direct mount	D†
Direct w/backstrap	B†

\* Only available on UL Listings.  
 † Contact Cooper MEDC if 1/2" NPT is required for UL version.