

MB010 Xenon Strobe Beacon

The MB010 is a 10 Joule Xenon strobe beacon featuring a robust, fire retardant, IP66 & IP67 housing; suitable for harsh environments.

Features

- Automatic synchronised flash, or Flip-Flop alternating mode.
- Xenon tube mechanically secured against vibration.
- Continuously rated.
- Large termination area.
- Stainless steel fixings.
- Ratchet adjustable stainless steel 'U' bracket for 360° positioning.
- Duplicate cable terminations (in & out for daisy-chain installations).
- Tropicalised as standard.

Approvals

- GOST-R approved. Cert: POCC GB.JB05.H00144.



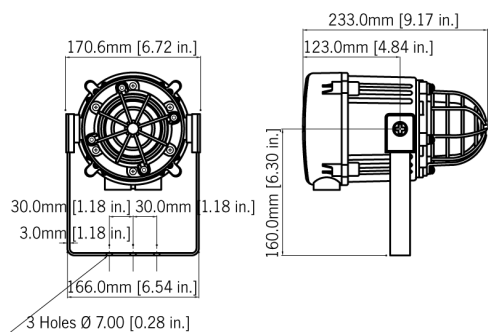

Specification

Energy:	10 Joules (10Ws)
Flash rate:	1Hz (60 fpm)
Peak Candela:	1,000,000 cd - calculated from energy (J)
Effective Intensity cd:	500 cd - calculated from energy (J)
Peak Candela:	43,920 cd* - measured ref. to I.E.S.
Effective Intensity cd:	183 cd* - measured ref. to I.E.S.
Lens colours:	Amber, Blue, Clear, Green, Red & Yellow
Voltages DC:	12V dc; 24V dc; 48V dc
Voltages AC:	115V ac; 230V ac
Ingress protection:	IP66 & IP67 (Third party tested)
Housing material:	High impact UL94 V0 & 5VA FR ABS
Colour:	Grey (RAL7038)
Cable entries:	2 x M20 supplied with 1 blanking plug
Lens material:	Borosilicate glass dome with PC prismatic lens cover.
Guard:	Stainless Steel dome guard as standard
Terminals:	0.5 to 4.0mm ² cables.
Operating temp:	-25 to +55°C [-13 to +131°F]
Storage temp:	-40 to +70°C [-40 to +158°F]
Relative humidity:	90% at 20°C [68°F]
Weight:	1.48kg/3.25lbs

*Candela measurements representative of performance with clear lens at optimum voltage.

Part Codes

Version:	Part code:
12V dc	MB010DC12G-[xx]
24V dc	MB010DC24G-[xx]
48V dc	MB010DC48G-[xx]
115V ac	MB010AC115G-[xx]
230V ac	MB010AC230G-[xx]

[xx] = Lens colour: AM: Amber, BL: Blue, CL: Clear, GN: Green, RD: Red, YW: Yellow

Also available as the MCA112-05 combined alarm sounder and Xenon beacon and the MCL15-05 15W PA Loudspeaker with Xenon beacon.

Current Consumption

Version:	Voltage:	Current mA:
12V dc	10-14V dc	1.45A
24V dc	20-28V dc	660mA
48V dc	42-54V dc	340mA
115V ac	50/60Hz +/-10%	250mA
230V ac	50/60Hz +/-10%	110mA

AUTHORIZED DISTRIBUTOR:
GasDetectorsUSA.com
Houston, Texas USA
sales@GasDetectorsUSA.com
832-615-3588