

GASGUARD CO₂ CARBON DIOXIDE SENSOR



Key Features

- CO₂ specific infrared sensor technology.
- No more special-order guesswork or added costs for heated or stainless enclosures
- Industry standard linear 4/20 mA output
- Corrosion, weather and chemical resistant polycarbonate sensor enclosure
- Sensor designed to adapt to any harsh environment from -60°F to +120°F
- Accurately monitor OSHA's PEL and STEL setpoints for personnel protection
- Real-time continuous monitoring
- 0-3% range (0/30,000 ppm) allows setpoints at both critical levels (0.5% & 3.0%)

Industrial strength CO₂ monitoring...for any harsh environment

The GasGuard CO₂ utilizes proven infrared sensor technology for fast and accurate leak detection. With no moving parts and no cells to replace, the GasGuard CO₂ provides real-time continuous monitoring and inexpensive long-term operating costs.

The GasGuard CO₂ is carbon dioxide specific, so false alarms from floor cleaners and food off-gassing is non-existent. The output signal is also not affected by moisture or drastic temperature variations such as washdowns, defrost cycles, etc.

The GasGuard CO₂ provides an industry standard linear 4/20 mA output signal compatible with most gas detection systems and PLCs. The high-quality injection-molded polycarbonate enclosure offers excellent chemical corrosion protection and high impact resistance.

Applications

- Wineries
- Food Processing areas
- Indoor Air Quality
- Bottling Plants
- Breweries
- Refrigeration Systems
- Perimeter Monitoring
- Chemical Plants

Benefits

- Versatile for any application
- Low cost
- Simple operation
- Rugged and reliable

GASGUARD CO₂

The standard **GasGuard CO₂** sensor comes equipped with a corrosion proof enclosure and adaptive temperature control, and is designed to work anywhere. With only one sensor for any application, designing, ordering and maintaining your CO₂ monitoring system is less hassle. The 0/3% range (0/30,000 ppm) is broad enough to handle OSHA's recommended alarm levels (0.5% and 3.0%), providing plenty of upper range detection for high output systems.

Designed "Food Industry" tough

The **GasGuard CO₂** is prepared to survive in just about any harsh industrial condition. Every sensor circuit board is sealed forever in potting compound, protecting electronic components and copper tracing from corrosion. A specially vented chemical-resistant polycarbonate enclosure protects the sensor from accidental damage, weather and even direct hose-hits from clean-up crews.

Ordering Information

The **GasGuard CO₂** is delivered calibrated and ready to install. Use the model numbers below to order.

Polycarbonate
GG-CO2-1%
GG-CO2-3% (standard)
GG-CO2-5%

Stainless steel
GG-CO2-3%-ST

NEW



Stainless steel enclosure option

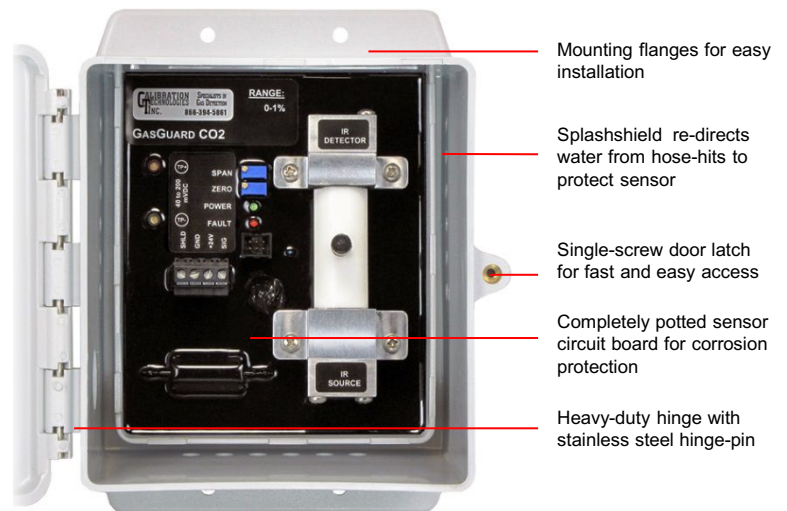

Mounting flanges for easy installation

Splashshield re-directs water from hose-hits to protect sensor

Single-screw door latch for fast and easy access

Completely potted sensor circuit board for corrosion protection

Heavy-duty hinge with stainless steel hinge-pin

SPECIFICATIONS

DUE TO ONGOING RESEARCH AND PRODUCT IMPROVEMENT, SPECIFICATIONS ARE SUBJECT TO CHANGE

DETECTION PRINCIPLE:

(NDIR) Non-Dispersive Infrared

DETECTION METHOD:

Diffusion

GAS:

Carbon Dioxide (CO₂)

RANGE:

0/1%
0/3% (standard)
0/5%

OUTPUT SIGNAL:

Linear 4/20 mA (max input impedance: 700 Ohms)

POWER SUPPLY:

+24 VDC, 350 mA

ACCURACY:

+/- 5% of value, but dependant on calibration gas accuracy

RESPONSE TIME:

T₅₀ = less than 30 seconds
T₉₀ = less than 60 seconds

ZERO DRIFT:

Less than 1% of full-scale per month, non-cumulative

SPAN DRIFT:

Less than 1% of full-scale per month, non-cumulative

LINEARITY:

+/- 3% of full-scale

REPEATABILITY:

+/- 3% of full-scale

WIRING CONNECTIONS:

3 conductor, shielded, stranded, 20 AWG cable (Belden 8772 or equivalent) up to 1500 ft.

ENCLOSURE:

Injection-molded NEMA 4X polycarbonate Hinged lid. For non-classified areas.

TEMPERATURE RANGE:

-60°F to +120°F (-51°C to +49°C)

HUMIDITY RANGE:

5% to 100% condensing

DIMENSIONS:

7.5" high x 6.5" wide x 3.75" deep

WEIGHT:

3 lbs